

Adjustable Arm Subject's Chair Wired with Activity Sensors

Setup and User's Manual



3700 Sagamore Parkway North
Lafayette, IN 47904 U.S.A.

Tel: (765) 423-1505

info@lafayetteinstrument.com

www.lafayetteinstrument.com

Adjustable Arm Subject's Chair Wired with Activity Sensors

A x 4 B x 6 C x 6 D x 4 E x 12 F x 4

G x 2 H x 2 I x 6

J x 2 P x 4

- A. 5/16"-18 Heavy Hex Nut
- B. 3/8"-16 Hex Nut
- C. 1/2" Split Lock Washer
- D. 5/16" Split Lock Washer
- E. 1/4"-20 x 3/4" Socket Head Cap Screw
- F. 1/4"-20 x 1/4" Button Head Socket Cap Screw

- G. 3/8" Shoulder x 3" Long, 5/16"-18 Thread
H. 3/8" Shoulder x 1-1/2" Long, 5/16" Thread
I. 1/2" Shoulder x 1-1/2" Long, 3/8"-16 Thread
J. 1/4" Diameter x 2" Clevis and Cotter Pin
P. 1-3/4" Knob, 1/4"-20 x 1/2" Stud

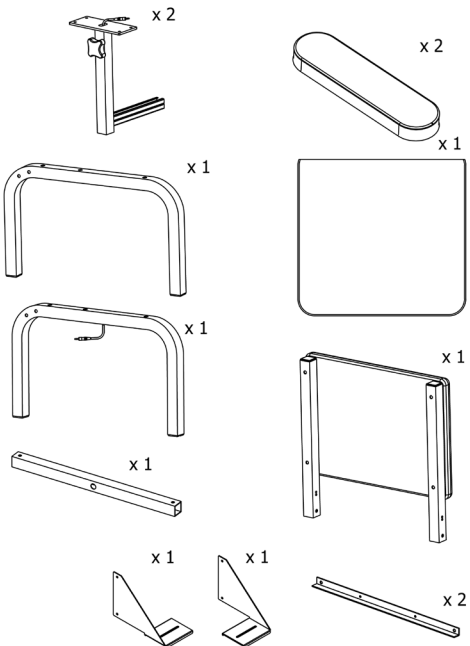

9/16" Wrench

3/16" Hex Key

1/4" Hex Key

5/32" Hex Key

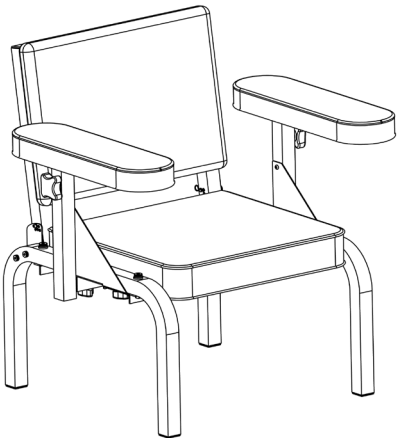

Step 1

Required Parts/Tools:

Part E: qty 4

3/16" Hex Key

- A. Attach the angles to the seat as shown. Do not tighten completely.

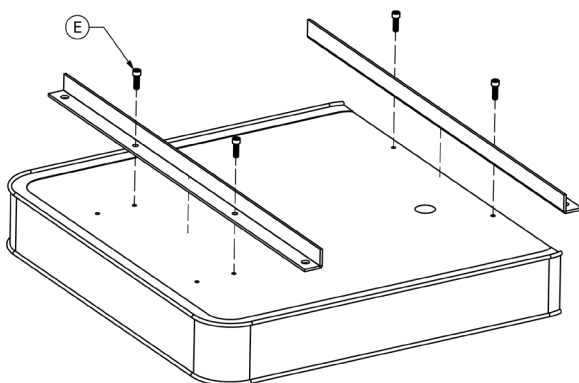

Step 2

Required Parts/Tools:

Part B: qty 6

Part C: qty 6

Part I: qty 6

9/16" Wrench

1/4" Hex Key

- A. Place the seat cushion upside down on floor.
- B. Attach the angle brackets to the legs. Make sure the thicker portion of the seat is furthest away from the two holes in the sides of the legs and the cable is coming out of the correct side.
- C. Attach the tube to the legs and angle brackets. Do not tighten completely. Make sure the hole in the tube is as shown.

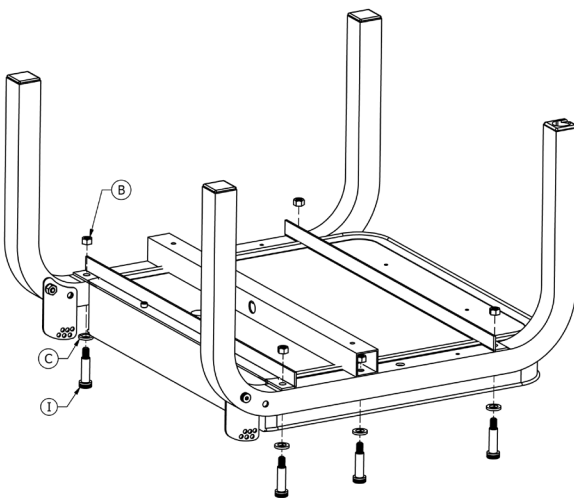

Adjustable Arm Subject's Chair Wired with Activity Sensors

Step 3

Required Parts/Tools:

Part P: qty 2

- A. Put the square nut into the bottom channel and slide the assembly gently into the tube as shown.
- B. When you can see the threaded hole in the square nut through the hole for the plastic knob thread the knob onto the square. The square nut may need to be slid further up the channel for easier installation.

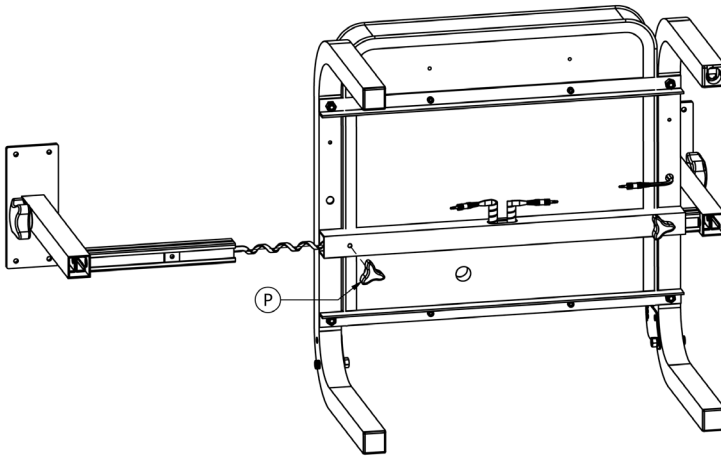

Step 4

Required Parts/Tools:

Part A: qty 2

Part D: qty 2

Part G: qty 2

Part J: qty 2

9/16" Wrench

3/16" Hex Key

- A. Attach the back piece as shown.
- B. Put the clevis pin through the plate and back tube and secure in place with the cotter pin.
- C. Make sure that everything is straight and tighten everything down.

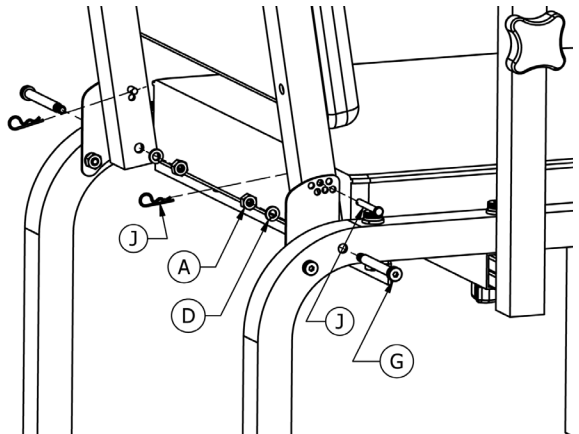

Step 5

Required Parts/Tools:

Part P: qty 2

Part F: qty 4

5/32" Hex Key

- A. Slide out the arms approximately as shown and attach the support plate with the screws and the small knobs.

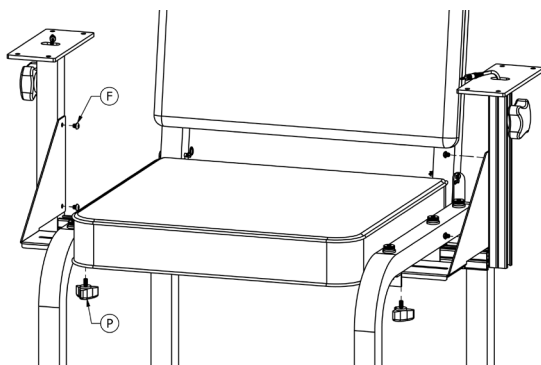

Step 6

Required Parts/Tools:

Part E: qty 8

3/16" Hex Key

- A. Attach the arm cushions to the plates. The cable must go up through the hole shown in order to use the arm sensors.

If you have an arm sensor, you must open up the arm and plug in the 3.5 mm cable.

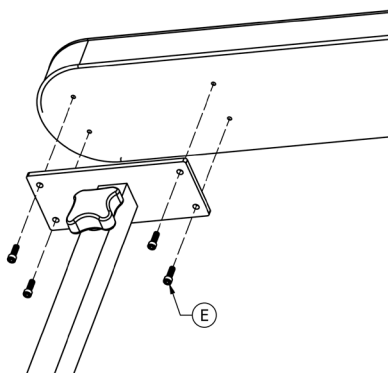

- B. Turn the knob clockwise to tighten into place at desired height. The knobs only need to be loosened a little bit to reposition the arms.

WARNING: Always hold onto the arm cushions when loosening the height adjustment handle to avoid injury.

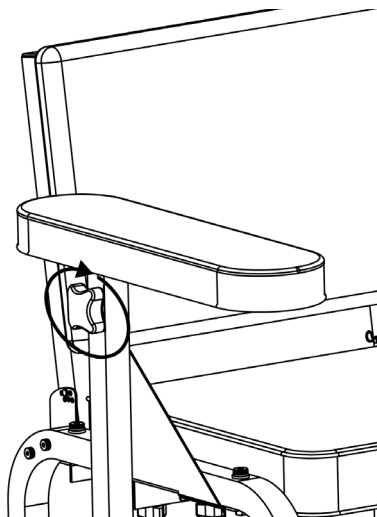

Adjustable Arm Subject's Chair Wired with Activity Sensors

Attaching the Sensor Mixer Box

Attach the mixer box using the supplied wood screws and bracket.

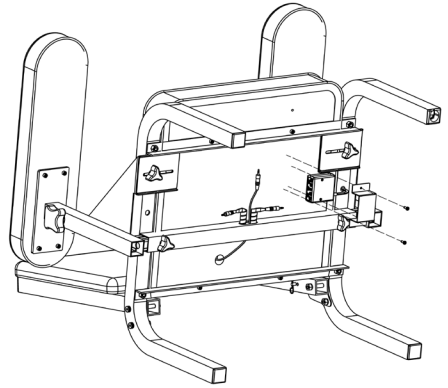

Using the Seat and Arm Sensors

To use the seat sensor run the cable that comes out of the seat cushion through the hole in the tube. Attach the cable to the input side of the Mixer Box labeled "FROM SEAT".

To use the arm sensors plug the cables into the Mixer Box plugs labeled "FROM ARMS". It does not matter which side is plugged into which input plug.

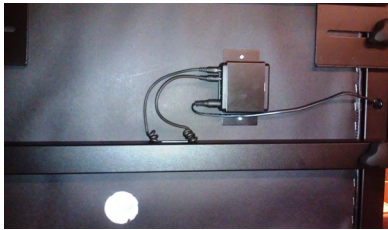
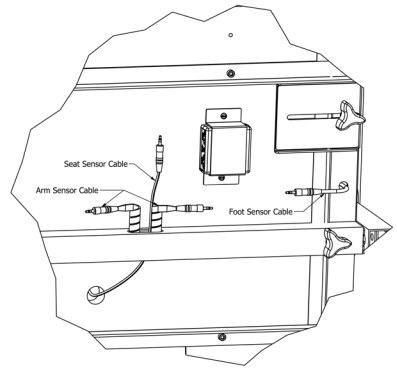

Using 76870FS - Foot Activity Sensor

To use the 76870FS, attach the male cable coming out of it into the female end in the left leg of the chair.

The cable coming out the center of the leg should be attached to the mixer box on the bottom of the chair. The input side of the box is the side with the plug labeled "FROM FEET".

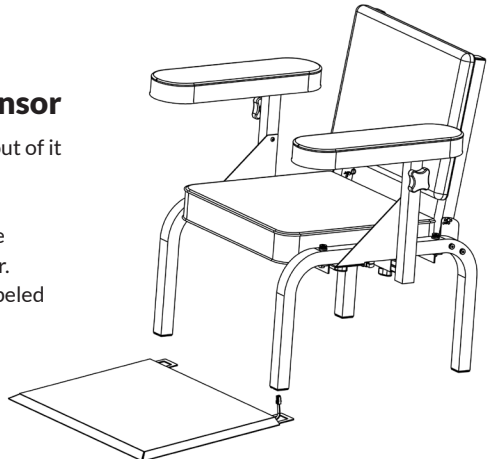

Sensor Mixer Box - Model 76879M

Sensors all plug into the input side. The output side plugs into either the DAS.

ALL

All activity signals viewed on a single channel (Arms, Feet, and Seat).

SEAT

The activity signal from the seat sensor viewed on a single channel.

FEET

The activity signal from the feet sensor viewed on a single channel.

ARMS

The activity signal from the arm sensors viewed on a single channel.

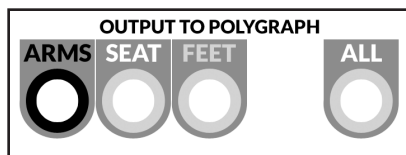

View of Mixer Box output to DAS

LX4000 and LX5000 Attachment to Mixer Box

LX4000

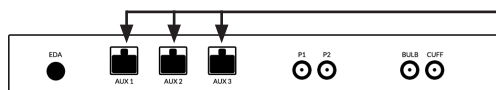

Input from Mixer: All, Feet, Seat, or Arms
Cat5E Connection (Model 76878CBL)

LX4000

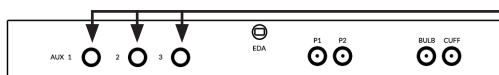

Input from Mixer: All, Feet, Seat, or Arms
3.5mm Stereo Connection (Model 3-382-019)

LX5000

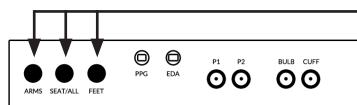

Input from Mixer: Arms, Seat/All, or Feet

The label on the LX5000 shows you what the LXSoftware will label the trace. If you insert the cable from the mixer box into the incorrect hole, the label in the software will not match the sensor being read.

3.5mm Stereo Connection (Model 3-382-019)

LX6

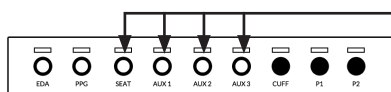

Input from Mixer: Seat/All, Arms, or Feet
Fischer Connector (Model 76878CBL-6)

Terms and Conditions

LIC Worldwide Headquarters

Toll-Free: (800) 428-7545 (USA only)

Phone: (765) 423-1505

Fax: (765) 423-4111

Email: sales@lafayetteinstrument.com

export@lafayetteinstrument.com (Outside the USA)

Mailing Address:

Lafayette Instrument Company

PO Box 5729

Lafayette, IN 47903, USA

Lafayette Instrument Europe:

Phone: +44 1509 817700

Fax: +44 1509 817701

Email: eusales@lafayetteinstrument.com

Phone, Fax, Email or Mail-in Orders

All orders need to be accompanied by a hard copy of your purchase order. All orders must include the following information:

- Quantity
- Part Number
- Description
- Your purchase order number or method of pre-payment
- Your tax status (include tax-exempt numbers)
- Shipping address for this order
- Billing address for the invoice we'll mail when this order is shipped
- Signature and typed name of person authorized to order these products
- Your telephone number
- Your email address
- Your FAX number

Domestic Terms

There is a \$50 minimum order. Open accounts can be extended to most recognized businesses. Net amount due 30 days from the date of shipment unless otherwise specified by us. Enclose payment with the order; charge with VISA, MasterCard, American Express, or pay COD. We must have a hard copy of your purchase order by mail, E-mail or fax. Students, individuals and private companies may call for a credit application.

International Payment Information

There is a \$50 minimum order. Payment must be made in advance by: draft drawn on a major US bank; wire transfers to our account; charge with VISA, MasterCard, American Express, or confirmed irrevocable letter of credit. Proforma invoices will be provided upon request.

Exports

For ordering instrumentation for use outside the USA, please specify the country of ultimate destination, as well as the power requirements (110V/60Hz or 220V/50Hz). Some model numbers for 220V/50Hz will have a "C" suffix.

Quotations

Quotations are supplied upon request. Written quotations will include the price of goods, cost of shipping and handling, if requested, and estimated delivery time frame. Quotations are good for 30 days, unless otherwise noted. Following that time, prices are subject to change and will be re-quoted at your request.

Cancellations

Orders for custom products, custom assemblies or instruments built to customer specifications will be subject to a cancellation penalty of 100%. Payment for up to 100% of the invoice value of custom products may be required in advance. Cancellation for a standard Lafayette Instrument manufactured product once the product has been shipped will normally be assessed a charge of 25% of the invoice value, plus shipping charges. Resell items, like custom products, will be subject to a cancellation penalty of 100%.

Exchanges and Refunds

Please see the cancellation penalty as described above. No item may be returned without prior authorization of Lafayette Instrument Company and a completed Return Form. A copy of the Return Form or your assigned Return # (you will receive this via email after submitting the form) **must be included with the returned goods**. The merchandise should be packed well and fully insured. Unopened merchandise may be returned prepaid within thirty (30) days after receipt of the item and in the original shipping carton. Collect shipments will not be accepted. Returned products must be in saleable condition, and credit is subject to inspection of the merchandise.

Repairs

Instrumentation may not be returned without prior authorization by Lafayette Instrument Company and a completed Return Form. When you

complete the Form, or call Lafayette Instrument, you will receive a Return #. Your Return # number will be good for 30 days. Address the shipment to:

Lafayette Instrument Company

3700 Sagamore Parkway North

Lafayette, IN 47904, USA.

Shipments cannot be received at the LIC PO Box. Items should be packed well, insured for full value, and returned along with a copy of the Return Form or the Return #. An estimate of repair will be given prior to completion ONLY if requested in an enclosed cover letter. We must have a completed purchase order by mail or fax, or repair work cannot commence for non-warranty repairs.

Damaged Goods

Damaged instrumentation should not be returned to Lafayette Instrument prior to a thorough inspection. If a shipment arrives damaged, note damage on delivery bill and have the driver sign it to acknowledge the damage. Contact the delivery service, and they will file an insurance claim. If damage is not detected at the time of delivery, contact the carrier/shipper and request an inspection within 10 days of the original delivery. Please call the Lafayette Instrument Customer Service Department for repair or replacement of the damaged merchandise.

Limited Warranty

Lafayette Instrument Company warrants equipment manufactured by the company to be free of defects in material and workmanship for a period of one year from the date of shipment, except as provided hereinafter. The original manufacturer's warranty will be honored by Lafayette Instrument for items not manufactured by Lafayette Instrument Company, i.e. resell items. This assumes normal usage under commonly accepted operating parameters and excludes consumable products.

Warranty period for repairs or used instrumentation purchased from Lafayette Instrument is 90 days. Lafayette Instrument Company agrees either to repair or replace, at its sole option and free of part charges to the customer, instrumentation which, under proper and normal conditions of use, proves to be defective within the warranty period. Warranty for any parts of such repaired or replaced instrumentation shall be covered under the same limited warranty and shall have a warranty period of 90 days from the date of shipment or the remainder of the original warranty period whichever is greater. This warranty and remedy are given expressly and in lieu of all other warranties, expressed or implied, of merchantability or fitness for a particular purpose and constitutes the only warranty made by Lafayette Instrument Company.

Lafayette Instrument Company neither assumes nor authorizes any person to assume for it any other liability in connection with the sale, installation, service or use of its instrumentation. Lafayette Instrument Company shall have no liability whatsoever for special, consequential, or punitive damages of any kind from any cause arising out of the sale, installation, service or use of its instrumentation. All products manufactured by Lafayette Instrument Company are tested and inspected prior to shipment. Upon prompt notification by the Customer, Lafayette Instrument Company will correct any defect in warranted equipment of its manufacture either, at its option, by return of the item to the factory, or shipment of a repaired or replacement part. Lafayette Instrument Company will not be obliged, however, to replace or repair any piece of equipment, which has been abused, improperly installed, altered, damaged, or repaired by others. Defects in equipment do not include decomposition, wear, or damage by chemical action or corrosion, or damage incurred during shipment.

Limited Obligations Covered by this Warranty

1. In the case of instruments not of Lafayette Instrument Company manufacture, the original manufacturer's warranty applies.
2. Shipping charges under warranty are covered only in one direction. The customer is responsible for shipping charges to the factory if return of the part is required.
3. This warranty does not cover damage to components due to improper installation by the customer.
4. Consumable and/or expendable items, including but not limited to electrodes, lights, batteries, fuses, O-rings, gaskets, and tubing, are excluded from warranty.
5. Failure by the customer to perform normal and reasonable maintenance on instruments will void warranty claims.
6. If the original invoice for the instrument is issued to a company that is not the company of the end user, and not an authorized Lafayette Instrument Company distributor, then all requests for warranty must be processed through the company that sold the product to the end user, and not directly to Lafayette Instrument Company.

Export License

The U.S. Department of Commerce requires an export license for any polygraph system shipment with an ULTIMATE destination other than: Australia, Japan, New Zealand or any NATO Member Countries. It is against U.S. law to ship a Polygraph system to any other country without an export license. If the ultimate destination is not one of the above listed countries, contact us for the required license application forms.